

2 PROPOSED NOTES

- DRAWING SET IS FOR DESIGN INTENT AND MUST BE FIELD VERIFIED
- CLEAR DIMENSIONS DICTATE OVER ALL OTHER DIMENSIONS
- PARTITIONS ARE CENTERED ON BUILDING COLUMN LINES AND MILLION GRID LINES UNLESS OTHERWISE NOTED. DIMENSIONS TO CORER WALL ARE TO FACE OF WALL UNLESS NOTED
- DIMENSIONS TO OUTSIDE WALL ARE TO INSIDE FACE OF SILL UNLESS OTHERWISE NOTED
- DIMENSIONS TO CORER WALL ARE TO FACE OF WALL UNLESS NOTED OTHERWISE
- PARTITIONS ARE Laid OUT AT 80 AND 45 ANGLES UNLESS NOTED OTHERWISE
- ALL WALLS ARE TO BE CONSTRUCTED TO UNDERSIDE ON CEILING UNLESS NOTED OTHERWISE
- CONTRACTOR SHOULD NOT SPECIFY CHANGES ORY WALL UNDER ANY CIRCUMSTANCES
- REPAIRS TO EXISTING PARTITIONS AND OFFICE WALKER TO BE PROVIDED BY TENANT AND INSTALLED BY GC AS PER REQUIREMENTS
- GC TO PROVIDE FIRE EXTINGUISHERS (NECESSED IN CABINET) AS PER LIFE SAFETY FLOOR PLAN
- DOOR LOCATIONS (TYP) - EDGE OF DOOR JAMB HINGE SIDE TO BE MEASURED FROM FACE OF ADJACENT PARTITION UNLESS NOTED OTHERWISE
- FOR DOORS REQUIRING CARD ACCESS CONTROL, DEVICES TO BE PROVIDED BY TENANT. PROVIDE TWO (2) FOR EACH LOCKSET AND TWO MASTER KEYS UPON COMPLETION. LOCKSETS WITH CONSTRUCTION KEY SYSTEM UNTIL DATE OF SUBSTANTIAL COMPLETION. KEYS TO OWNER
- ALL EXISTING PRESERVED DOOR HARDWARE TO BE RE-USED. HARDWARE QUALITY IS TO BE BASED ON ALE HAGAN OR APPROVED EQUIVALENT. CONSULT WITH HARDWARE SPECIALIST FOR REPAIRS AND REPLACEMENTS. SUBMIT EXAMPLES TO TENANT FOR APPROVAL FROM DATE OF FINAL INSTALLATION. SUBMIT EXAMPLES TO TENANT FOR APPROVAL
- CORE DRILLING OF DOORS WITH CARD READERS TO BE PROVIDED BY GC
- MAILBOX IN RECEPTION #100 TO BE PROVIDED BY TENANT AND INSTALLED BY GC
- AS PER SEC 11-4.1 (02) THE PATH OF TRAVEL TO THE ALTERED AREA AND THE RESTROOMS, TELEPHONE AND DRINKING FOUNTAIN SERVING THE ALTERED AREA ARE REPAIRABLE ACCESSIBLE TO AND USABLE BY INDIVIDUALS WITH DISABILITIES

1 (PROPOSED) FLOOR PLAN

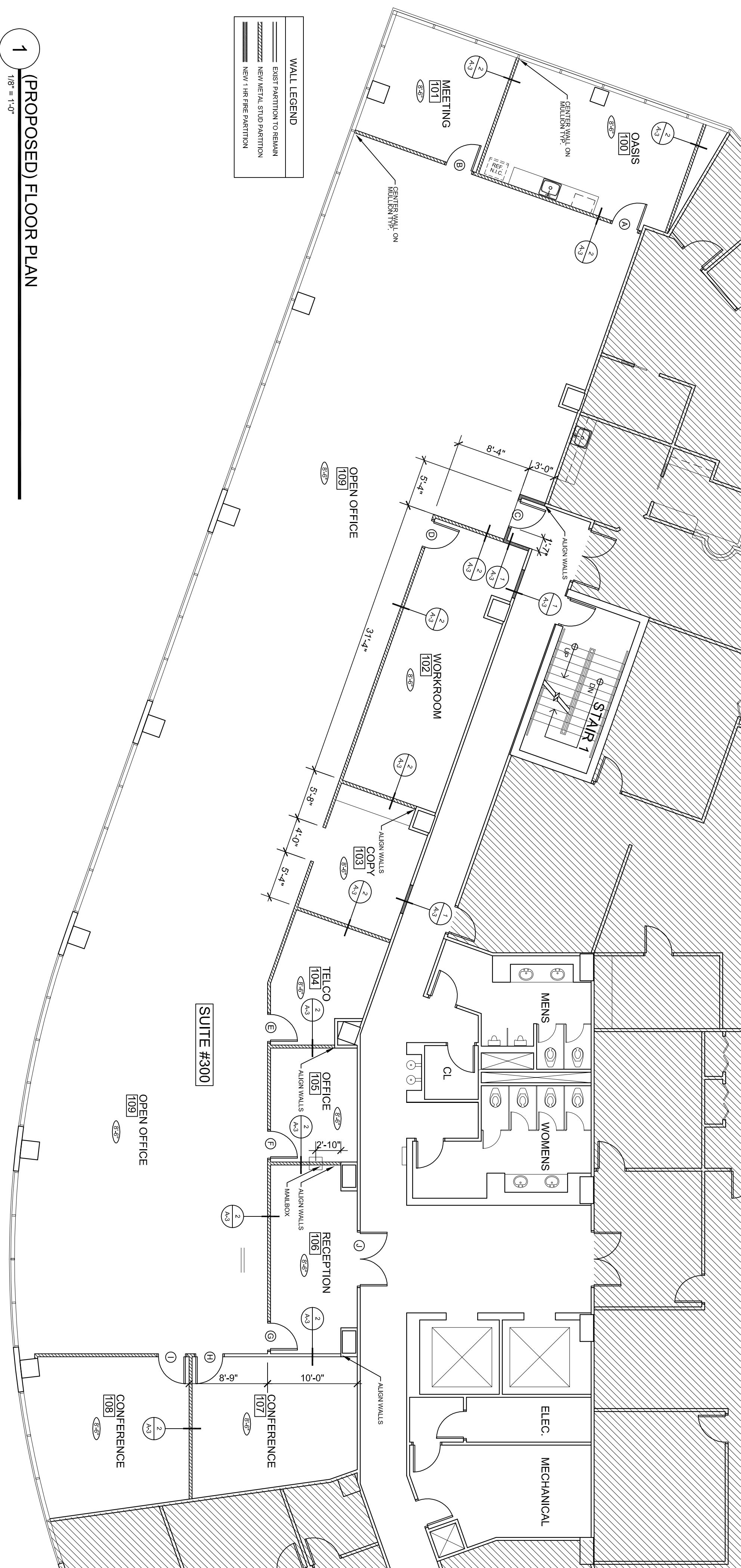

2 PROPOSED NOTES

- DRAWING SET IS FOR DESIGN INTENT AND MUST BE FIELD VERIFIED
- CLEAR DIMENSIONS DICTATE OVER ALL OTHER DIMENSIONS
- PARTITIONS ARE CENTERED ON BUILDING COLUMN LINES AND MILLION GRID LINES UNLESS OTHERWISE NOTED. DIMENSIONS TO CORER WALL ARE TO FACE OF WALL UNLESS NOTED
- DIMENSIONS TO OUTSIDE WALL ARE TO INSIDE FACE OF SILL UNLESS OTHERWISE NOTED
- DIMENSIONS TO CORER WALL ARE TO FACE OF WALL UNLESS NOTED OTHERWISE
- PARTITIONS ARE Laid OUT AT 80 AND 45 ANGLES UNLESS NOTED OTHERWISE
- ALL WALLS ARE TO BE CONSTRUCTED TO UNDERSIDE ON CEILING UNLESS NOTED OTHERWISE
- CONTRACTOR SHOULD NOT SPECIFY CHANGES ORY WALL UNDER ANY CIRCUMSTANCES
- REPAIRS TO EXISTING PARTITIONS AND OFFICE WALKER TO BE PROVIDED BY TENANT AND INSTALLED BY GC AS PER REQUIREMENTS
- GC TO PROVIDE FIRE EXTINGUISHERS (NECESSED IN CABINET) AS PER LIFE SAFETY FLOOR PLAN
- DOOR LOCATIONS (TYP) - EDGE OF DOOR JAMB HINGE SIDE TO BE MEASURED FROM FACE OF ADJACENT PARTITION UNLESS NOTED OTHERWISE
- FOR DOORS REQUIRING CARD ACCESS CONTROL, DEVICES TO BE PROVIDED BY TENANT. PROVIDE TWO (2) FOR EACH LOCKSET AND TWO MASTER KEYS UPON COMPLETION. LOCKSETS WITH CONSTRUCTION KEY SYSTEM UNTIL DATE OF SUBSTANTIAL COMPLETION. KEYS TO OWNER
- ALL EXISTING PRESERVED DOOR HARDWARE TO BE RE-USED. HARDWARE QUALITY IS TO BE BASED ON ALE HAGAN OR APPROVED EQUIVALENT. CONSULT WITH HARDWARE SPECIALIST FOR REPAIRS AND REPLACEMENTS. SUBMIT EXAMPLES TO TENANT FOR APPROVAL FROM DATE OF FINAL INSTALLATION. SUBMIT EXAMPLES TO TENANT FOR APPROVAL
- CORE DRILLING OF DOORS WITH CARD READERS TO BE PROVIDED BY GC
- MAILBOX IN RECEPTION #100 TO BE PROVIDED BY TENANT AND INSTALLED BY GC
- AS PER SEC 11-4.1 (02) THE PATH OF TRAVEL TO THE ALTERED AREA AND THE RESTROOMS, TELEPHONE AND DRINKING FOUNTAIN SERVING THE ALTERED AREA ARE REPAIRABLE ACCESSIBLE TO AND USABLE BY INDIVIDUALS WITH DISABILITIES

1 (PROPOSED) FLOOR PLAN

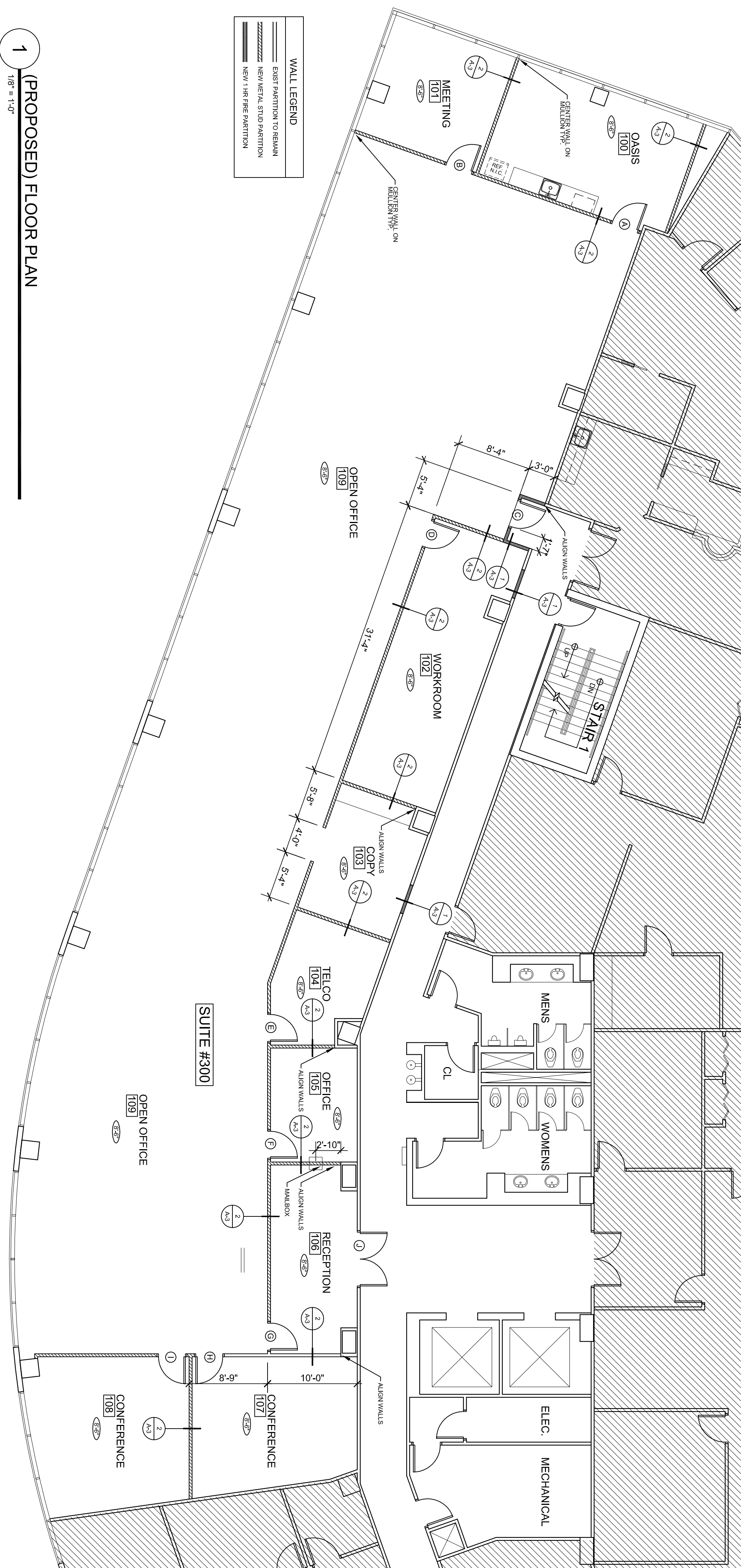

3 (PROPOSED) CEILING PLAN

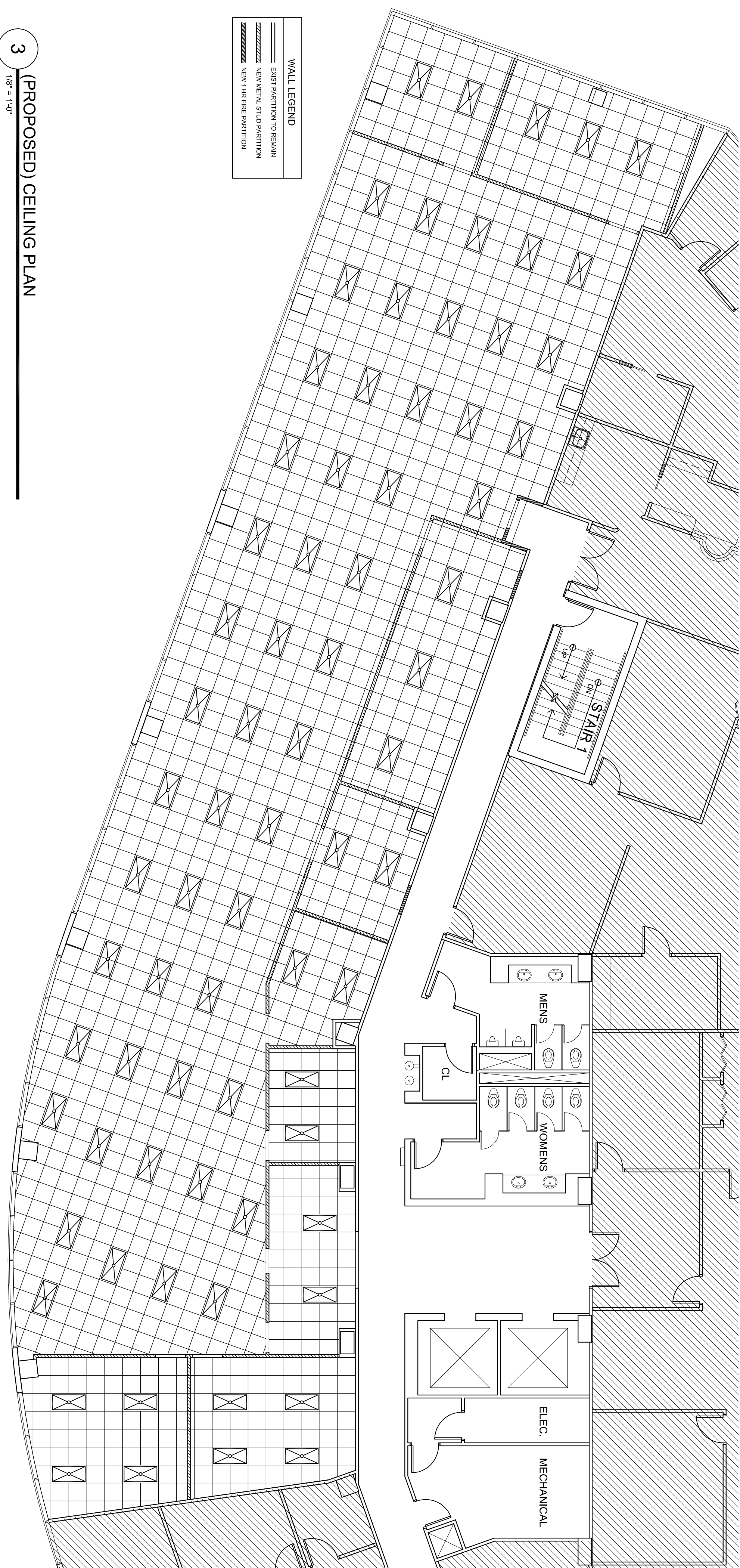

4 CEILING NOTES

- EXISTING GRID, CEILING TILES AND FIXTURES TO BE REUSED IF POSSIBLE
- CLEAN ALL EXISTING MATERIALS THAT ARE TO BE REUSED

4 CEILING NOTES